



TECHNICAL PACKAGE

**200A LAKESHORE DRIVE
REGINA, SASKATCHEWAN
CANADA
S4S 7L3**

www.conexusartscentre.ca

CONEXUS ARTS CENTRE CAPITAL AUTO THEATRE

ADMINISTRATION STAFF

CHIEF EXECUTIVE OFFICER	Neil Donnelly	(306) 565-4500
THEATRE SERVICES MANAGER	Amanda Partridge amandap@conexusartscentre.ca	(306)565-4534
DIRECTOR OF CLIENT SERVICES	Shari Tourscher shari.tourscher@conexusartscentre.ca	(306-565-4516)
THEATRE SERVICES ASSISTANT	Emily Barton emilyb@conexusartscentre.ca	(306) 565-4504
BOX OFFICE COORDINATOR	Christine Hamilton boxoffice@conexusartscentre.ca	(306) 565-4500

TECHNICAL CONTACTS

HEAD STAGE CARPENTER	Dana Rempel headcarp@conexusartscentre.ca	(306)565-4529
HEAD AUDIO TECHNICIAN	Mitch Zaleschuk head.audio@conexusartscentre.ca	(306) 565-4531
HEAD LIGHTING TECHNICIAN	Riley Richter headlighting@conexusartscentre.ca	(306) 565-4537

RENTAL INFORMATION

Please contact Amanda Partridge amandap@conexusartscentre.ca directly for booking information and rates.

CATERING INFORMATION

The Conexus Arts Centre is a fully equipped Banquet and Convention facility. Please contact a Client Service Representative for more information at (306) 565-4500.

BOX OFFICE INFORMATION

The Conexus Arts Centre Box Office (CBO) uses ETIX computerized ticketing software. For more information please contact the Box Office directly at (306) 565-4500.

TECHNICAL INFORMATION

THEATRE SEATING: (Continental style - no center aisle) - Capacity 2031 seats

Main Level	1249 (includes 8 wheelchair)	
	Using the Pit - 1157	
1st Balcony	268	
2nd Balcony	264	
3rd Balcony	250	

PROSCENIUM OPENING: Flex Proscenium (Moveable Sound Towers) 30'H X 55'W

FORESTAGE: U. S. Edge of Proscenium to D. S. Edge of Apron 6' 0"

WORKSTAGE:

U. S. Edge of Proscenium to back wall		53'9"
Width from Centre line to SR		85'8"
Width from Centre line to SL		85'8"
Overall Width of Stage		171'4"
Overall Depth of Stage		59'9"

WING SPACE:

S. L. - 38'W X 48'D	
S. R. - 38'W X 26'D	

STAGE DECK:

Stagelam Composite	
Over 1 1/2" edge grain spruce	
Sprung for dance	
Working load limit (average)	100 lbs/sq. in.

ORCHESTRA PIT:

Hydraulic Lift D. S. of apron	
Capacity	30,000 lbs
Travel Rate	8' / min
Dimensions:	
Width @ U.S. edge	53'
Width @ D.S. edge	65'6"
Depth	13'

ORCHESTRA SHELL:

Variable Depth and Height	
4 Flown Ceiling Pieces	
18 Rolling Towers	
Approximate time required to set up – 1.5 hours	

GENIE LIFT: In house 35' Genie Lift with rechargeable DC

RISERS: New Risers: 26 – 4x8', 8 – 4x6', 2 – 4' (various leg heights available 8" to 24")
Older Style: all 4' x 8' decks
Heights: 20 @ 8", 20 @ 16", 20 @ 24", 16 @ 32"

FLY SYSTEM: Double Purchase Counterweight
Lock rail located @ S.R. Gallery
Batten Length 75'
Batten Diameter 2 & 7/8ths "
Line Distance - 8" Centres

GRID HEIGHT: 92' Main Grid
65' Forestage Mini Grid (FOH LX points & Audio)

PIANOS: Performance Quality
2 - 9' Steinway Grand
1 - Yamaha U3 Upright
1 – Heintzman Baby Grand (Theatre Lobby)

MUSIC STANDS: Manhasset 30
Lights 30

TRUCK LOADING: Loading Area 27' X 38'
U. S. Right - Direct access to stage area
Dock level equal to Truck loading level
Capacity - 2 Truck Sealed Bays
Unlimited Bus and Truck Parking
No Parking Permits Required
Shore Power available upon request

STAGE POWER: Located Onstage
3-400 amp services 3 Phase (2 W/Camlock Located MSR)
2-200 amp services 3 Phase (W/Camlock, 1 MSR, 1 DSL)
4-50 amp services single phase (w/Stove Plug Located DSR, DSL, MSL, MSR)

LABOR: Stagehands/Wardrobe/Hair & Make Up Technicians
Supplied through IATSE Local #295
Yellow Card may be sent to Business Agent or Stage Carpenter at:
200A Lakeshore Drive
Regina, Saskatchewan
S4S 7L3

DRESSING ROOMS:

Stage Level:

6 rooms: 2 - 4 persons

All equipped with sink, toilet, shower, mirror & lights

Green Room

Comfortable setting for 20 - 30 persons

2nd Level:

2 Chorus Dressing Rooms: 20 - 30 persons

All equipped with sink, toilet, shower, mirror & lights

1 Dressing Room/Rehearsal Room: 20-30 persons

Equipped with sink, toilet, shower, mirror & lights,
Mirrors/Barre/Wood floor

REHEARSAL ROOM:

3rd Level

Mirrors/Barre/Wood floor (approximately 1456 sq ft)

Only available with prior written notice

WARDROBE:

2nd Level

2 irons & boards, steamer, 2 Washers & 3 Dryers

Conexus Arts Centre

CONEXUS ARTS CENTRE - AUDIO

CONTACT: MITCH ZALESCHUK – Head Audio Technician

House Mix Position - Permanent in booth on the main floor under the 1st balcony.

Tour Mix Position - Last 3 Rows of the Main Level Under the First Balcony - 20 seats per row

Rental costs apply to some audio equipment – contact us for a quote.

Touring Audio Power:

200 Amp/3 Phase W/Camlock Connection (Stage Left Downstage Wall)

Refer to Stage setup for other power specs.

HOUSE SPEAKER SYSTEM: (Rental costs apply)

12 Adamson S10 hi-mid cabinet per side

6 Adamson iS119 subwoofer per side

6 Adamson iS7p front fill

Lab Gruppen D120/D200 amplifiers, Lake processing

Tour patch available at FOH or DSL for LEFT, RIGHT, SUBS, FILLS using analog or Dante via Lake LM44

Centre Cluster (mono)

2 EAW LF SB118 subwoofer

4 EAW KF300 mid-hi

EAW MX300i Processor, QSC amplification

HOUSE CONSOLES:

Yamaha QL5 Permanently located in Audio Booth - **no remote I/O**

Yamaha M7CL-48

MONITORS:

5 Yamaha CM15V

2 QSC PLX2402 amplifiers

HOUSE DISTRIBUTED PROGRAM/PAGING SYSTEM

Backstage Paging System - combination of Toa and Bose, with individual volume control per dressing room.

HOUSE INTERCOM:

Wired Technical Projects Clear Com System

Patch points available DSL, DSR, MSL, MSR, USL, USR, Fly Rail, and Tour Mix Position

Permanent Posts located in Audio Booth, LX Booth, Spot Booth (x4), Fly Rail

12 Technical Projects Beltpack

12 Technical Projects Headset

MICROPHONES

9 Sennheiser e845
2 Sennheiser e845s
6 Shure SM 57
2 Shure SM58S
10 Shure SM58
1 Shure Beta 56
1 Sennheiser MD421
5 Sennheiser e604
1 Sennheiser e901
2 Sennheiser e609
2 Sennheiser e914
2 AKG 214
5 Rode NT-5
2 Crown PCC-160
1 Crown PZM-30PG
2 Neumann KM184

DI'S:

2 Radial Pro D2
4 Radial Pro D1
3 Radial JDI
1 Radial JDI Stereo
1 Whirlwind HotBox
4 ART AV Direct
4 Radial ProAV1

WIRELESS MICROPHONES

8 Sennheiser ew300G3 Receivers:
8 Sennheiser skm300G3 845 handheld
8 Sennheiser sk300 G3 belt packs
8 Apex 575 headset mics
1 Shure ULXD4Q-G50 *installed in audio booth
4 Shure ULXD1 Body pack
4 Shure ULXD2 handheld transmitter with SM58 capsule
5 Shure TH53 headsets (1 black, 4 beige)

OTHER EQUIPMENT:

EAW KF650/SB528 system consisting of 2 EAW SB528,
4 EAW KF650E with Xilica Processing, Yamaha PCN
Amplifiers

10 Yamaha DXR12/DXR12mkII
2 Yamaha DXS18XLF
2 Yamaha DSR118W
1 Yamaha MSR100 (Portable Powered Speaker)
2 Mackie SRM150

AV Equipment:

- 2 Panasonic ET-DLE085 short throw zoom lens
- 2 Da-Lite 38315 fast fold screen – 88"x140"
- 2 Panasonic PTRX870BU 8500 lumen projectors
- 2 PTZ Optics PT20X-NDI-ZCAM box camera
- 4 PTZ Optics 20X-NDI PTZ camera
- 1 PTZ Optics PTZ camera joystick/controller
- 1 Roland V160HD video switcher
- 1 Roland V1-SDI video switcher
- 2 Roland UVC-01 capture card
- 8 Blackmagic HDMI to SDI converter
- 8 Blackmagic SDI to HDMI converter
- 1 Blackmagic Designs ATEM Mini Pro ISO
- 1 Atomos Shinobi 7 monitor
- 2 ViewSonic 24" monitors

Conexus Arts Centre

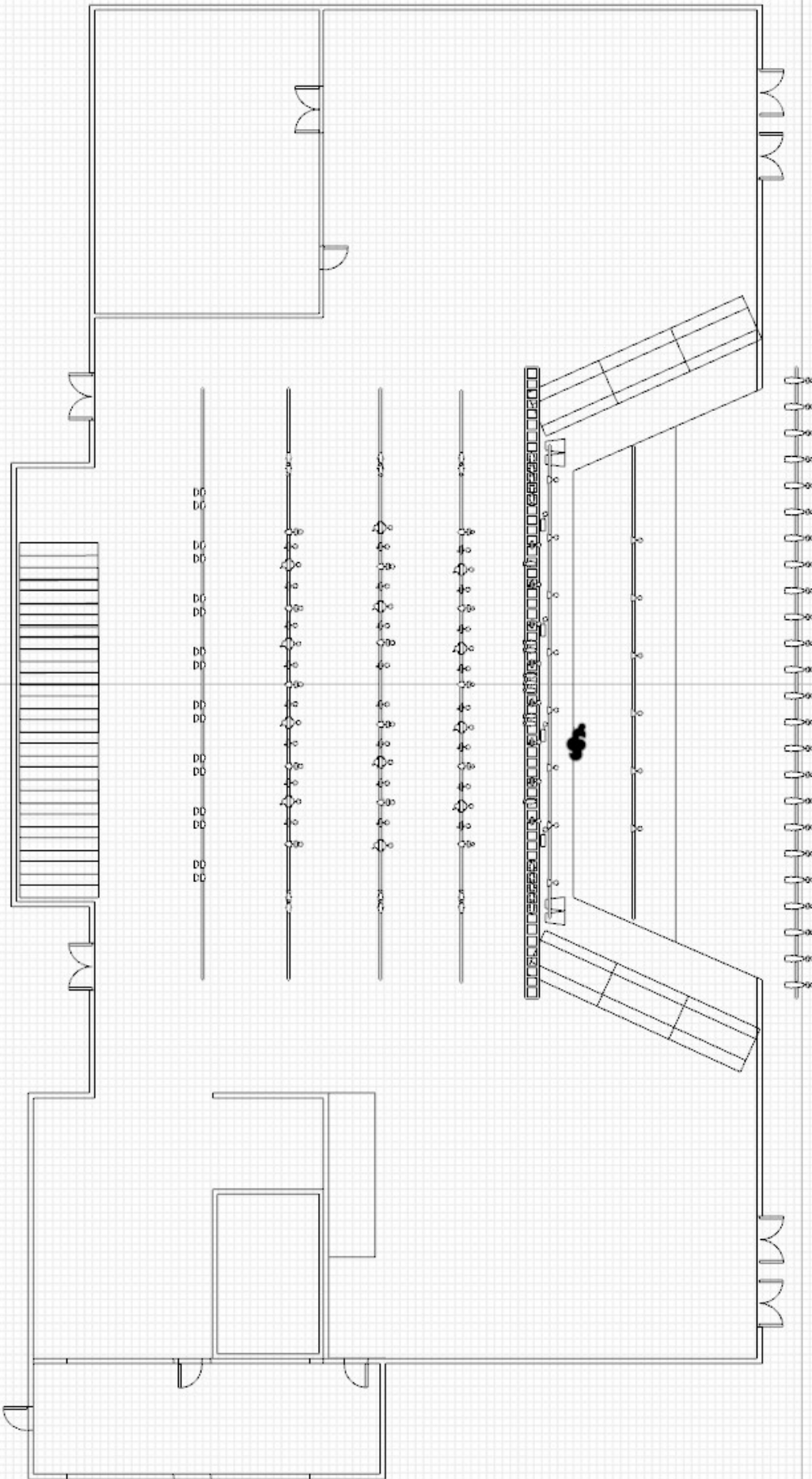

22 22 22 22 22 22 22 22 22 22 22 22

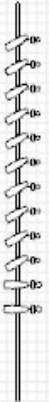

CONEXUS ARTS CENTRE - LINESET SCHEDULE

LINESET	PURPOSE	DISTANCE FOM LX 1	ARBOUR TYPE	MAX BATTEN		Notes
				WEIGHT	RESTRICTIONS	
1	First Electrics	0'0"	LARGE	1400lb		
2	Grand Valance	1'	SMALL	900lb		
3	Grand Drape	1'8"	LARGE	1400lb	DIFFICULT PULL WHEN GUILLOTINE	
4	REMOVED		N/A			
5	Electrics TRUSS	2'10"	N/A	>2000lb	LX BRIDGE TRUSS	
6	Leg #1	5'6"	SMALL	900lb	ADJUSTABLE OPENING ON 20' TRACK	
7	Acoustical Baffle	6'6"	N/A		MOTOR ASSISTED ORCHESTRA BAFFLE	
8	Border #1	8'5"	SMALL	900lb		
9	SPARE	9'1"	SMALL	900lb		
10	SPARE	9'9"	SMALL	900lb		
11	Leg #2	10'4"	MEDIUM	1100lb	ADJUSTABLE OPENING ON 20' TRACK	
12	SPARE	10'11"	SMALL	900lb		
13	Second Electrics	12'	X-LARGE	1300lb		
14	Border #2	13'1"	SMALL	900lb		
15	SPARE	13'8"	SMALL	900lb		
16	1/4 Stage Traveller	14'8"	MEDIUM	1100lb	USED AS LEG WHEN NOT FULL BLACK	
17	SPARE	15'3"	SMALL	900lb		
18	SPARE	15'9"	SMALL	900lb		
19	Acoustical Baffle	17'	N/A		MOTOR ASSISTED ORCHESTRA BAFFLE	
20	SPARE	18'3"	SMALL	900lb		
21	SPARE	18'11"	SMALL	900lb		
22	Border #3	19'7"	SMALL	900lb		
23	SPARE	20'2"	MEDIUM	1100lb		
24	Leg #3	20'11"	SMALL	900lb	ADJUSTABLE OPENING ON 20' TRACK	
25	SPARE	21'6"	SMALL	900lb		
26	Third Electrics	22'4"	X-LARGE	1300lb		
27	Border #4	23'11"	SMALL	900lb		
28	SPARE	24'9"	SMALL	900lb		
29	1/2 Stage Traveller	25'5"	LARGE	1400lb	USED AS LEG WHEN NOT FULL BLACK	
30	SPARE	26'4"	SMALL	900lb		
31	SPARE	27'3"	SMALL	900lb		
32	SPARE	27'11"	SMALL	900lb		
33	Acoustical Baffle	28'8"	N/A		MOTOR ASSISTED ORCHESTRA BAFFLE	
34	SPARE	30'	SMALL	900lb		
35	SPARE	30'8"	SMALL	900lb		
36	Border #5	31'4"	SMALL	900lb		
37	SPARE	31'11"	SMALL	900lb		
38	Leg #4	32'6"	MEDIUM	100lb	ADJUSTABLE OPENING ON 20' TRACK	
39	SPARE	33'1"	SMALL	900lb		
40	Fourth Electrics	34'5"	X-LARGE	1300lb		
41	SPARE	35'1"	SMALL	900lb		
42	SPARE	35'9"	SMALL	900lb		
43	3/4 Stage Traveller	36'9"	MEDIUM	1100lb	USED AS LEG WHEN NOT FULL BLACK	
44	SPARE	37'5"	SMALL	900lb		
45	SPARE	37'11"	SMALL	900lb		
46	Acoustical Baffle	39'8"	N/A		MOTOR ASSISTED ORCHESTRA BAFFLE	
47	SPARE	41'9"	SMALL	900lb		
48	Border #6	42'5"	SMALL	900lb		
49	SPARE	43'1"	SMALL	900lb		
50	SPARE	43'9"	SMALL	900lb		
51	Fifth Electrics	45'	X-LARGE	1300lb		
52	SPARE	45'6"	SMALL	900lb		
53	BORDER #7	46'3"	SMALL	900lb		
54	SPARE	47'	SMALL	900lb		
55	US Traveller	47'8"	MEDIUM	1100lb	USED AS LEG WHEN NOT FULL BLACK	
56	SPARE	48'5"	SMALL	900lb		
57	SPARE	49'	SMALL	900lb		
58	CYCLORAMA	49'8"	SMALL	900lb		
59	SPARE	50'5"	SMALL	900lb		

****PLEASE NOTE PIPE BATTEN DIAMETER IS 2&7/8" RATHER THAN 2"
IF 2" IS REQUIRED, PLEASE CONTACT US IN ADVANCE TO MAKE PROPER ARRANGEMENTS****

CONEXUS ARTS CENTRE - CAPITAL AUTO MALL THEATRE

etcNET NODES

ITEM	IP	LOCATION
Main Console	10.101.100.32	BOOTH
Backup Console	10.101.100.31	BOOTH
House Lights	10.101.51.110	DIMMING
House Dimming	10.101.51.109	DIMMING
LX1	10.101.51.101	
LX2	10.101.51.102	
Bridge	10.101.51.100	
LX3	10.101.51.103	
LX4	10.101.51.104	
LX5	10.101.51.105	
LX6	10.101.51.106	
Near FOH	10.101.51.111	NEAR FOH COVE
Far FOH	10.101.51.112	FAR FOH COVE
4-Port Node		GUEST FOH
Hazer Cart 1		SR
Hazer Cart 2		SL
SR Node		SR
SL Node		SL
SPARE NODE		

CONEXUS ARTS CENTRE - CAPITAL AUTO MALL THEATRE

POWER RELAYS FOR AUTOMATION (PARK AT 100%)

LINESET	FIXTURES	ADDRESS
LX1	LINEAR	1/47, 1/48, 1/51, 1/52
LX2	LINEAR	1/61, 1/62, 1/63, 1/64
BRIDGE	AURA	1/100, 1/103
	BLINDER	1/99, 1/104
LX3	AURA	1/120, 1/121, 1/133, 1/136
	QUANTUM	1/122, 1/135
LX4	AURA	1/143, 1/144, 1/167, 1/168
	QUANTUM	1/142, 1/169
LX5	AURA	1/175, 1/176, 1/197, 1/198
	QUANTUM	1/174, 1/199
LX6	CF72 UP CYC	1/202, 1/203, 1/204, 1/211, 1/212

CONEXUS ARTS CENTRE - CAPITAL AUTO MALL THEATRE

FAR FOH

10.101.51.112

FIXTURE TYPE	ADDRESS	PURPOSE
S4 Zoom 15/30	1/1	Apron lighting
S4 Zoom 15/30	1/2	Apron lighting
S4 Zoom 15/30	1/3	Blue front fill
S4 Zoom 15/30	1/4	Red front fill
S4 Zoom 15/30	1/5	Blue front fill
S4 Zoom 15/30	1/6	Red front fill
S4 Zoom 15/30	1/7	Blue front fill
S4 Zoom 15/30	1/8	Red front fill
S4 Zoom 15/30	1/9	White fill
S4 Zoom 15/30	1/10	White fill
S4 Zoom 15/30	1/11	White fill
S4 Zoom 15/30	1/12	White fill
S4 Zoom 15/30	1/13	Red front fill
S4 Zoom 15/30	1/14	Blue front fill
S4 Zoom 15/30	1/15	Red front fill
S4 Zoom 15/30	1/16	Blue front fill
S4 Zoom 15/30	1/17	Red front fill
S4 Zoom 15/30	1/18	Blue front fill
S4 Zoom 15/30	1/19	Apron lighting
S4 Zoom 15/30	1/20	Apron lighting
S4 Zoom 15/30 (PAIR)	1/354	Curtain warmer
S4 Zoom 15/30 (PAIR)	1/358	Curtain warmer

CONEXUS ARTS CENTRE - CAPITAL AUTO MALL THEATRE

NEAR FOH

10.101.51.111

FIXTURE TYPE	ADDRESS	PURPOSE
S4 Zoom 15/30	1/21	Cool (R61)
S4 Zoom 15/31	1/22	Warm (R02)
S4 Zoom 15/32	1/23	O/W
S4 Zoom 15/33	1/24	Cool (R61)
S4 Zoom 15/34	1/25	Warm (R02)
S4 Zoom 15/35	1/26	O/W
S4 Zoom 15/36	1/27	Cool (R61)
S4 Zoom 15/37	1/28	Warm (R02)
S4 Zoom 15/38	1/29	O/W
S4 Zoom 15/39	1/30	Cool (R61)
S4 Zoom 15/40	1/31	Warm (R02)
S4 Zoom 15/41	1/32	O/W
S4 Zoom 15/42	1/33	O/W
S4 Zoom 15/43	1/34	Warm (R02)
S4 Zoom 15/44	1/35	Cool (R61)
S4 Zoom 15/45	1/36	O/W
S4 Zoom 15/46	1/37	Warm (R02)
S4 Zoom 15/47	1/38	Cool (R61)
S4 Zoom 15/48	1/39	O/W
S4 Zoom 15/49	1/40	Warm (R02)
S4 Zoom 15/50	1/41	Cool (R61)
S4 Zoom 15/51	1/42	O/W
S4 Zoom 15/52	1/43	Warm (R02)
S4 Zoom 15/53	1/44	Cool (R61)

TOWER GOBO

SR FIXTURES 10 DEG/ZOOM	1/181	GOBO PROJECTION ON TOWERS
SL FIXTURES 10 DEG/ZOOM	1/185	GOBO PROJECTION ON TOWERS

HOUSE LIGHTS

PORTAL DOOR LIGHTS	1/368
SCONCES/UNDER BALCONY	1/369
HOUSE 1 (FARTHEST FROM STAGE)	1/450
HOUSE 2	1/451
HOUSE 3	1/452
HOUSE 4	1/453
HOUSE 5	1/454
HOUSE 6	1/455
HOUSE LX1 (ABOVE PIT)	1/456

CONEXUS ARTS CENTRE - CAPITAL AUTO MALL THEATRE

LX1

10.101.51.101

FIXTURE TYPE	ADDRESS	PURPOSE
COLORSOURCE LINEAR 4 (4Cell 5Ch MC)	6/1	ORCHESTRA PIT TOPLIGHT
COLORSOURCE LINEAR 4 (4Cell 5Ch MC)	6/21	ORCHESTRA PIT TOPLIGHT
COLORSOURCE LINEAR 4 (4Cell 5Ch MC)	6/41	ORCHESTRA PIT TOPLIGHT
COLORSOURCE LINEAR 4 (4Cell 5Ch MC)	6/61	ORCHESTRA PIT TOPLIGHT
COLORSOURCE LINEAR 4 (4Cell 5Ch MC)	6/81	ORCHESTRA PIT TOPLIGHT
COLORSOURCE LINEAR 4 (4Cell 5Ch MC)	6/101	ORCHESTRA PIT TOPLIGHT

LX2

10.101.50.62

COLORSOURCE LINEAR 4 (4Cell 5Ch MC)	6/121	CURTAIN WARMER/DS TOPLIGHT
COLORSOURCE LINEAR 4 (4Cell 5Ch MC)	6/141	CURTAIN WARMER/DS TOPLIGHT
COLORSOURCE LINEAR 4 (4Cell 5Ch MC)	6/161	CURTAIN WARMER/DS TOPLIGHT
COLORSOURCE LINEAR 4 (4Cell 5Ch MC)	6/181	CURTAIN WARMER/DS TOPLIGHT
COLORSOURCE LINEAR 4 (4Cell 5Ch MC)	6/201	CURTAIN WARMER/DS TOPLIGHT
COLORSOURCE LINEAR 4 (4Cell 5Ch MC)	6/221	CURTAIN WARMER/DS TOPLIGHT
COLORSOURCE LINEAR 4 (4Cell 5Ch MC)	6/241	CURTAIN WARMER/DS TOPLIGHT
COLORSOURCE LINEAR 4 (4Cell 5Ch MC)	6/261	CURTAIN WARMER/DS TOPLIGHT

CONEXUS ARTS CENTRE - CAPITAL AUTO MALL THEATRE

BRIDGE

10.101.51.100

FIXTURE TYPE	ADDRESS	PURPOSE	POSITION
RUSH 1 WW BLINDER (4Ch)	2/201		
RUSH 1 WW BLINDER (4Ch)	2/205		
RUSH 1 WW BLINDER (4Ch)	2/209		
RUSH 1 WW BLINDER (4Ch)	2/213		
MAC AURAxB (Extended)	2/1		-17.5'
MAC AURAxB (Extended)	2/26		-12.5'
MAC AURAxB (Extended)	2/51		-7.5'
MAC AURAxB (Extended)	2/76		-2.5'
MAC AURAxB (Extended)	2/101		2.5'
MAC AURAxB (Extended)	2/126		7.5'
MAC AURAxB (Extended)	2/151		12.5'
MAC AURAxB (Extended)	2/176		17.5'
SL 26	1/80		
SL ZOOM 23/50	1/78		
SL 26	1/76		
S4 36	1/74	B/U Tip	
S4 26	1/72	B/U Tip	
SL ZOOM 23/50	1/94		
SL ZOOM 23/50	1/86		
S4 36	1/101		
S4 19	1/98		
S4 50	1/69		
S4 19	1/71		
S4 26	1/73		
SL ZOOM 23/50	1/75		
SL ZOOM 23/50	1/108		
S4 26	1/91	B/U Tip	
S4 36	1/93	B/U Tip	
SL 26	1/95		
SL ZOOM 23/50	1/97		
SL 26	1/110		

CONEXUS ARTS CENTRE - CAPITAL AUTO MALL THEATRE

LX 3

10.101.51.103

FIXTURE TYPE	ADDRESS	PURPOSE	POSITION
MAC AURAxB (Extended)	3/1		-17.5'
MAC AURAxB (Extended)	3/26		-12.5'
MAC AURAxB (Extended)	3/51		-7.5'
MAC AURAxB (Extended)	3/76		-2.5'
MAC AURAxB (Extended)	3/101		2.5'
MAC AURAxB (Extended)	3/126		7.5'
MAC AURAxB (Extended)	3/151		12.5'
MAC AURAxB (Extended)	3/176		17.5'
MAC QUANTUM PROFILE (Extended)	3/201		-15'
MAC QUANTUM PROFILE (Extended)	3/228		-5'
MAC QUANTUM PROFILE (Extended)	3/255		5'
MAC QUANTUM PROFILE (Extended)	3/282		15'
S4 36	1/118	B/U Tip	
S4 26	1/117	B/U Tip	
S4 PAR	1/111		
S4 PAR	1/112		
S4 PAR	1/131		
S4 PAR	1/124		
S4 PAR	1/125		
S4 26	1/132	B/U Tip	
S4 36	1/137	B/U Tip	

CONEXUS ARTS CENTRE - CAPITAL AUTO MALL THEATRE

LX 4

10.101.51.104

FIXTURE TYPE	ADDRESS	PURPOSE	POSITION
MAC AURAxB (Extended)	4/1		-17.5'
MAC AURAxB (Extended)	4/26		-12.5'
MAC AURAxB (Extended)	4/51		-7.5'
MAC AURAxB (Extended)	4/76		-2.5'
MAC AURAxB (Extended)	4/101		2.5'
MAC AURAxB (Extended)	4/126		7.5'
MAC AURAxB (Extended)	4/151		12.5'
MAC AURAxB (Extended)	4/176		17.5'
MAC QUANTUM PROFILE (Extended)	4/201		-22.5'
MAC QUANTUM PROFILE (Extended)	4/228		-12.5'
MAC QUANTUM PROFILE (Extended)	4/255		12.5'
MAC QUANTUM PROFILE (Extended)	4/282		22.5'
S4 36	1/145	B/U Tip	
S4 26	1/146	B/U Tip	
S4 PAR	1/147		
S4 PAR	1/150		
S4 PAR	1/161		
S4 PAR	1/164		
S4 26	1/165	B/U Tip	
S4 36	1/166	B/U Tip	

CONEXUS ARTS CENTRE - CAPITAL AUTO MALL THEATRE

LX 5

10.101.51.105

FIXTURE TYPE	ADDRESS	PURPOSE	POSITION
MAC AURAxB (Extended)	5/1		-17.5'
MAC AURAxB (Extended)	5/26		-12.5'
MAC AURAxB (Extended)	5/51		-7.5'
MAC AURAxB (Extended)	5/76		-2.5'
MAC AURAxB (Extended)	5/101		2.5'
MAC AURAxB (Extended)	5/126		7.5'
MAC AURAxB (Extended)	5/151		12.5'
MAC AURAxB (Extended)	5/176		17.5'
MAC QUANTUM PROFILE (Extended)	5/201		-15'
MAC QUANTUM PROFILE (Extended)	5/228		-5'
MAC QUANTUM PROFILE (Extended)	5/255		5'
MAC QUANTUM PROFILE (Extended)	5/282		15'
S4 36	1/177	B/U Tip	
S4 26	1/178	B/U Tip	
S4 PAR	1/179		
S4 PAR	1/180		
S4 PAR	1/189		
S4 PAR	1/193		
S4 PAR	1/194		
S4 26	1/195	B/U Tip	
S4 36	1/196	B/U Tip	

CONEXUS ARTS CENTRE - CAPITAL AUTO MALL THEATRE

LX 6

10.101.51.106

FIXTURE TYPE	ADDRESS	PURPOSE
COLORFORCE 72 (M4)	8/1	TOP CYC
COLORFORCE 72 (M4)	8/49	TOP CYC
COLORFORCE 72 (M4)	8/97	TOP CYC
COLORFORCE 72 (M4)	8/145	TOP CYC
COLORFORCE 72 (M4)	8/193	TOP CYC
COLORFORCE 72 (M4)	8/241	TOP CYC
COLORFORCE 72 (M4)	8/289	TOP CYC
COLORFORCE 72 (M4)	8/337	TOP CYC
COLORFORCE 72 (M4)	8/385	TOP CYC

CONEXUS ARTS CENTRE - CAPITAL AUTO MALL THEATRE

FLOOR PACKAGE

FIXTURE TYPE	ADDRESS	
MAC AURAxB (Extended)	7/31	
MAC AURAxB (Extended)	7/56	
MAC AURAxB (Extended)	7/81	
MAC AURAxB (Extended)	7/106	
MAC AURAxB (Extended)	7/131	
MAC AURAxB (Extended)	7/156	
MAC AURAxB (Extended)	7/181	
MAC AURAxB (Extended)	7/206	
MAC QUANTUM PROFILE (Extended)	7/231	
MAC QUANTUM PROFILE (Extended)	7/258	
MAC QUANTUM PROFILE (Extended)	7/285	
MAC QUANTUM PROFILE (Extended)	7/312	
MAC QUANTUM PROFILE (Extended)	7/339	
MAC QUANTUM PROFILE (Extended)	7/366	
COLORSOURCE LINEAR 4 (4Cell 5Ch MC)	7/393	
COLORSOURCE LINEAR 4 (4Cell 5Ch MC)	7/413	
COLORSOURCE LINEAR 4 (4Cell 5Ch MC)	7/433	
COLORSOURCE LINEAR 4 (4Cell 5Ch MC)	7/453	
COLORSOURCE LINEAR 4 (4Cell 5Ch MC)	7/473	
COLORSOURCE LINEAR 4 (4Cell 5Ch MC)	7/493	
RADIENCE HAZER	7/28	DMX CONTROLLABLE
VERSA FAN	7/30	DMX CONTROLLABLE
COLORFORCE 72 (M4)	9/1	GROUNDROW CYC
COLORFORCE 72 (M4)	9/49	GROUNDROW CYC
COLORFORCE 72 (M4)	9/97	GROUNDROW CYC
COLORFORCE 72 (M4)	9/145	GROUNDROW CYC
COLORFORCE 72 (M4)	9/193	GROUNDROW CYC
COLORFORCE 72 (M4)	9/241	GROUNDROW CYC
COLORFORCE 72 (M4)	9/289	GROUNDROW CYC
COLORFORCE 72 (M4)	9/337	GROUNDROW CYC
COLORFORCE 72 (M4)	9/385	GROUNDROW CYC
COLORFORCE 72 (M4)	10/1	SIDE KIT BOOM
COLORFORCE 72 (M4)	10/49	SIDE KIT BOOM
COLORFORCE 72 (M4)	10/97	SIDE KIT BOOM
COLORFORCE 72 (M4)	10/145	SIDE KIT BOOM
COLORFORCE 72 (M4)	10/193	SIDE KIT BOOM
COLORFORCE 72 (M4)	10/241	SIDE KIT BOOM
COLORFORCE 72 (M4)	10/289	SIDE KIT BOOM
COLORFORCE 72 (M4)	10/337	SIDE KIT BOOM

CONEXUS ARTS CENTRE - THEATRE INVENTORY

ITEM	QUANTITY	NOTES
CONTROL		
ETC IonXE 20 console	2	One main, One backup
ETC Eos 40Ch fader wing	1	Connected to main console
ETC remote tablet	1	
AUTOMATION/LED		
Martin AuraXB	40	32 hung permanently, 8 available in floor package
Martin Quantum Profile	18	12 hung permanently, 6 available in floor package
ETC Colorsource 6' Linear	20	14 hung permanently, 6 available in floor package
Elation Cuepix Blinder WW4	8	4 hung permanently, 4 available in floor package
ChromaQ Colorforce72	26	9 hung permanently, 9 available in floor package, 8 on boom kit
CONVENTIONAL		
ETC Source4 Zoom 23-50°	48	Permanently hung Near FOH and Far FOH
ETC Source4 Body	48	Various hang location, additional fixtures available
ETC Source4 Barrel 10°	2	Some used in house hang, others available
ETC Source4 Barrel 19°	6	Some used in house hang, others available
ETC Source4 Barrel 26°	18	Some used in house hang, others available
ETC Source4 Barrel 36°	28	Some used in house hang, others available
ETC Source4 Barrel 50°	4	Some used in house hang, others available
ETC Source4 Par	19	14 hung, 5 available
Strand SL Zoom 23-50°	6	Used in house hang
Strand SL 26°	4	Used in house hang
FOLLOWSPOT		
Lycian M2 Followspot	2	
Strong Super Trouper Followspot	2	
ATMOSPHERE		
LaMaitre Radiance Hazer	2	DMX Controllable
Ultratec Versa-fan	2	DMX Controllable
AUXILIARY		
Pinspot	50	
Festoon string (50')	47	
Small white christmas light string (100')	40	
Vertical Boom	8	Adjustable from 6-10', with top cross pipe for additional fixture position
ADJ ULTRABAR 10 LED BAR	11	
ADJ MEGA GO PAR64 PLUS LED PAR	11	
ADJ UB 12H LED BAR	24	

- When possible, a lighting plot would be appreciated in advance of arrival
- Accessories, such as power distribution for band equipment, orchestra lights, offstage worklight, specials and most other incidental equipments are available
- Please advise us of any special requirements in advance of the show arrival
- House automated fixtures can be removed, but can not be relocated

CONEXUS ARTS CENTRE - CONVENTION HALL

BASE HANG

FRONT WASH

FIXTURE TYPE	PATCH	NOTES
S4 JUNIOR ZOOM	1/18	
S4 PAR	1/4	
S4 PAR	1/4	
S4 JUNIOR ZOOM	1/6	
S4 JUNIOR ZOOM	1/10	
S4 PAR	1/23	
S4 PAR	1/23	
S4 JUNIOR ZOOM	1/9	
S4 JUNIOR ZOOM	1/14	
S4 PAR	1/20	
S4 PAR	1/20	
S4 JUNIOR ZOOM	1/11	
S4 PAR X2	1/16	Side lighting for stage
SL ZOOM X2	1/8	Located Centre of room, commonly used for gobo projection

BACK OF HOUSE

S4 PAR X2	1/3	Rear Right of room
S4 PAR X2	1/7	Rear centre of room
SL ZOOM X2	1/21	Rear centre of room
S4 PAR X2	1/19	Rear Left of room
FESTOON ROOM LIGHTS	1/13	Permanently installed above main room area

CONEXUS ARTS CENTRE - SHUMIATCHER ROOM

BASE HANG

FIXTURE TYPE	PATCH	NOTES
House Light	1/1	
House Light	1/2	
House Light	1/3	
House Light	1/4	
Strand SL Zoom	1/5	Along SL side of room
Strand SL Zoom	1/6	Along SL side of room
Strand SL Zoom	1/7	Along SL side of room
Strand SL Zoom	1/8	Along SL side of room
Strand SL Zoom	1/9	Along rear of room
Strand 6x12 Leko	1/11	Along rear of room
Strand 6x16 Leko	1/12	Along rear of room
Strand 6x12 Leko	1/10	Along rear of room
Strand SL Zoom	1/9	Along rear of room
Strand SL Zoom	1/8	Along SR side of room
Strand SL Zoom	1/7	Along SR side of room
Strand SL Zoom	1/6	Along SR side of room